

WEICHAI | **LOVOL**



Engine	WEICHAI LOVOL
Engine Mark	WEICHAI
Rated Power	160kW / 153.9kW
Operating Weight	23500kg (standard arm) / 24950kg (long arm)

Model
FR245E₂
HYDRAULIC EXCAVATOR

Engine

Arm Type	Standard Arm	Long Arm
Engine	WEICHAI LOVOL	
Engine Trademark	WEICHAI	
Engine Model	WP7HG218E303	WP6HG210E303
Engine Type	Common Rail Diesel Engine, 4 Stroke, 24 Valves, Inline, Direct Injection, Turbo-charger, Water Cooled	
Number of Cylinder-Bore×Stroke	6-107×126mm	6-104×122mm
Engine Power / Speed	160kW / 2000rpm	153.9kW / 2000rpm
Engine Torque / Speed	1006N·m / 1300rpm	1008N·m / 1400rpm
Displacement	6.8L	6.2L
Fuel Tank Capacity	380L	

- In heavy duty working applications, the main computer controller automatically adjusts power and speed according to the change of the load to ensure high output power, so as to the efficiency will be improved significantly

Walking drive

Arm Type	Standard Arm	Long Arm
Type	Hydrostatic	
Speed Level	Automatic two-speed travel motor	
Travel Speed (Max. / Min)	5.5km/h / 3.2km/h	
Gradeability	35°	
Upper Roller / Lower Roller (each side)	2 / 9	
Track Guides (each side)	2	
Ground Pressure	45.7kPa	
Shipping Length (1)	9560mm	12820mm
Length to Center of Rollers (2)	3630mm	
Undercarriage Length (3)	4430mm	
Track Type	Triple grouser	
Track Width (4)	600mm	800mm
Track Gauge (5)	2370mm	
Undercarriage Width (6)	2970mm	3170mm

- The track can be adjustable of tension.
- The left and right track driving independently.

Hydraulic System

Hydraulic Pump	Variable displacement
Hydraulic Flow	444L/min
Hydraulic Pressure	37.3MPa
Hydraulic Oil Tank Capacity	220L

- Hydraulic safety lock.

Cab

- All weather steel cap with safety glass, ROPS/FOPS cab, safe work, air condition
- Adjustable suspension seat with safety belt is very comfortable
- Wipers, radio FM/AM/USB
- LCD Display screen: 4 power modes (ECO mode, power mode, smart mode, breaker mode) hour meter, voltage charger, water-cooling temperature, engine oil pressure, hydraulic oil pressure, fuel level, etc., and add trouble code diagnostic and maintenance monitor functions which are convenient for operator to find the failure and do the routine maintenance on time

Electrical System

Electric system	24V
Battery	12V 120Ah × 2 units

Working Performance

Arm Type	Standard Arm	Long Arm
Bucket Type	Standard Bucket With Teeth And Side Cutter	
Bucket Capacity (ISO Heaped)	1.20m ³	0.45m ³
Bucket Digging Force	156kN	143kN
Arm Digging Force	109kN	108kN
Max. Traction Force	193kN	
360° Swing Speed	11r/min	
Max. Digging Radius On Ground Level (A)	9800mm	15400mm
Max. Digging Depth (B)	6500mm	11700mm
Max. Unloading Height (C)	7260mm	12500mm
Max. Digging Height (D)	10190mm	15200mm

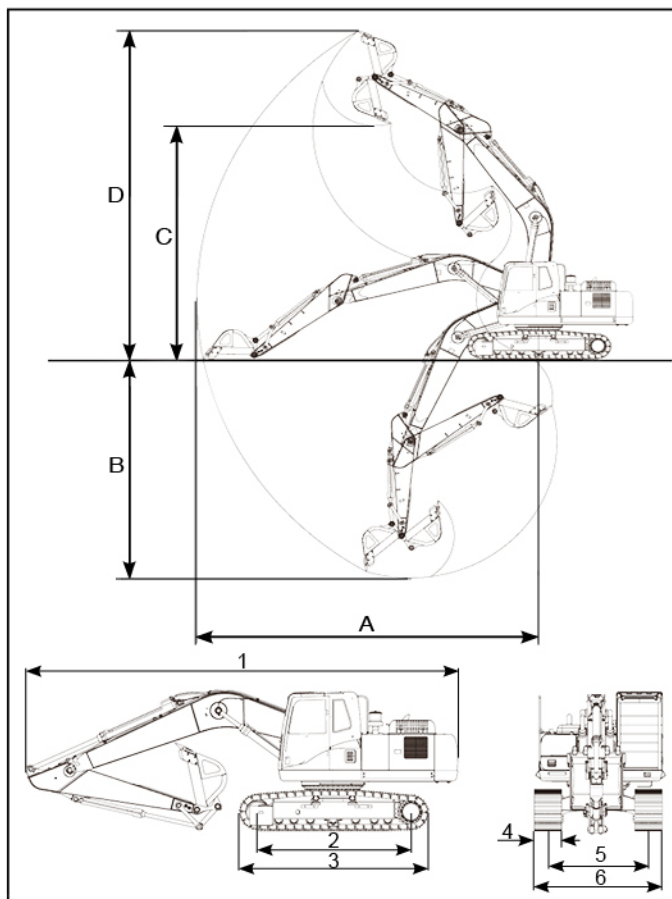

Optional Configuration

- 0.40m³ Bucket
- 0.50m³ Bucket
- Quick coupler
- Cab front guard
- Rear view camera
- GPS system on android, IOS
- Radio FM/AM/USB/CD